

The SS7000 speaker (Fig.1) is designed for use in Quick Service Restaurant (QSR) menu boards, speaker posts, and enclosures. The SS7000 must be used in conjunction with the IB7000 interface box (i.e., the speaker does not connect directly to the base station). See Fig. 4, the IB7000 Installation Guide or NEXEO | HDX system Installation Guide for more details.

Tools/Equipment Required

- General hand tools: screwdrivers, cutters, pliers, wire strippers, etc.
- Serrated knife
- Audio Cable (not included)
- Acoustic Foam (not included)

These instructions are for a typical installation.

1. Strip approximately 1 inch (25.4 mm) of insulation from the end of the audio cable and ¼ inch (6.35 mm) of insulation from each of the four cable wires, but do not tin the wires. Connect the audio cable wires to the connector plug.
2. Insert the connector plug into the speaker connector (see Fig. 2).
3. Position the speaker inside the speaker post or menu board, with the gasket centered against the inside of the speaker grill; see Fig. 3. Align the opening in the gasket with the grill opening.
4. Remove both inserts from the molded foam enclosure and place the foam enclosure around the speaker. Trim foam with a serrated knife if necessary. Place removed foam inserts behind speaker to provide pressure to speaker, to ensure a good gasket seal against the speaker grill opening.
5. Connect the other end of the audio cable to the IB7000. The four wires on the SS7000 connect to terminals 4,5, 6, and 7 of the seven-pin DM5 MIC | SPKR connector on the IB7000 (this connector is labeled on the IB7000).
6. Connect audio cable between the three-pin PLC/ BASE connector on the IB7000 and J4500 on the base station (this connector is also labeled on the IB7000). See Fig. 4 and Table 1.



Fig. 1

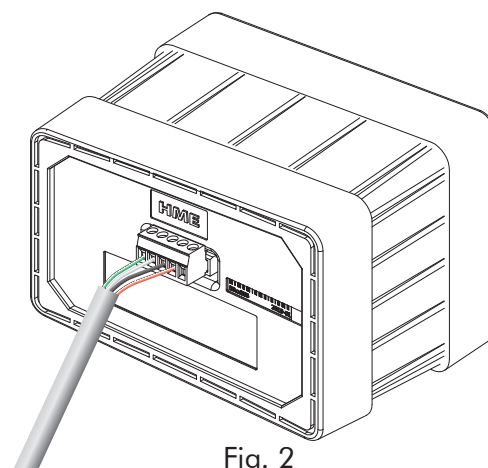

Fig. 2

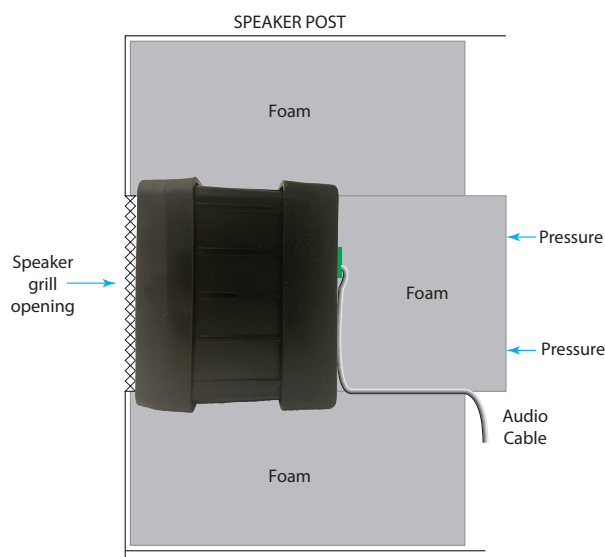

Fig. 3

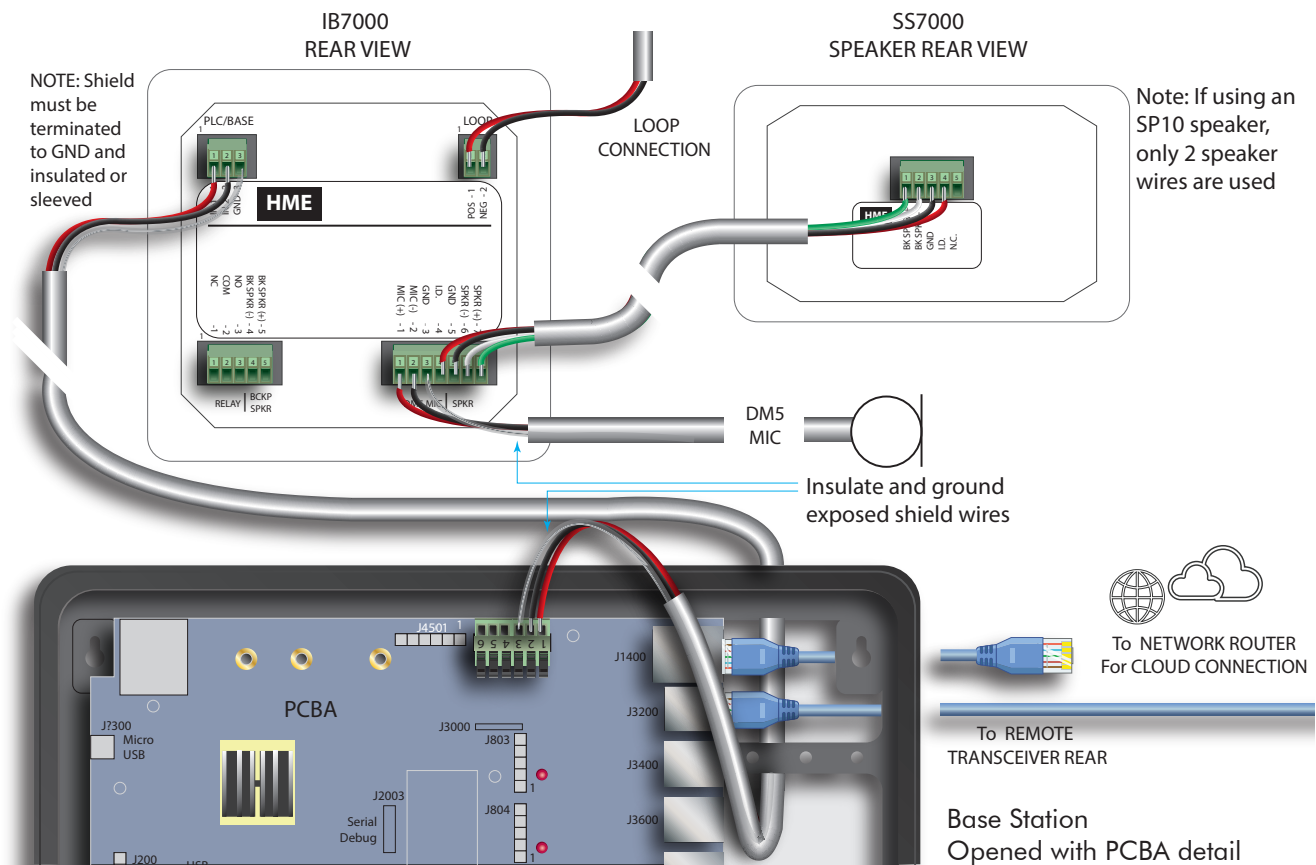
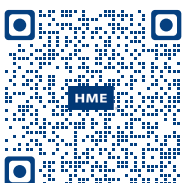

Fig. 4

SS7000	to	IB7000 DM5 MIC SPKR,	IB7000 PLC/BASE	to	Base Station J4500
Pin 1: Spkr +		Pin 7: Spkr +	Pin 1: IN1/PL+		Pin 1: Spkr/Mic PL +
Pin 2: Spkr -		Pin 6: Spkr -	Pin 2: IN2/PL -		Pin 2: Spkr/Mic PL -
Pin 3: GND		Pin 5: GND	Pin 3: GND (shield)		Pin 3: Shield
Pin 4: I.D.		Pin 4: I.D.,			

Table 1

SS7000 Technical Specifications	
Dimensions	5.76" W x 3.92" H x 3.44" D (146.3 x 99.6 x 87.4 mm)
Weight	1.14 lb (492.6 g)
Power Supply	Voltage: 48 VDC, powered from BS7000
Frequency Range	Audio: 100 Hz to 7.4 kHz
Power	15 Watts, 8 ohm
Rear Panel	Phoenix connector type headers
Wireless	N/A
Temperature	Operating Temperature range: -25°C (-13°F) and +60°C (+140°F)
Compliance	See NEXEO HDX - Regulatory, Compliance, and Safety Guide online



A copy of this guide and more can be found by scanning this QR code or going to:
<https://www.hme.com/qsr/drive-thru-user-manuals/>

The HME logo and product names are registered trademarks or trademarks of HM Electronics, Inc.